

MODEL NO. LMD17S13BDB15-160 DWG NO. A6570

| REV. | REVISION RECORD | BY  | DATE      |
|------|-----------------|-----|-----------|
| 0    | ORIGIN          | MYX | 4.15.2026 |

CUSTOMER'S MODEL: NO MODEL  
END COVER COLOR: BLACK

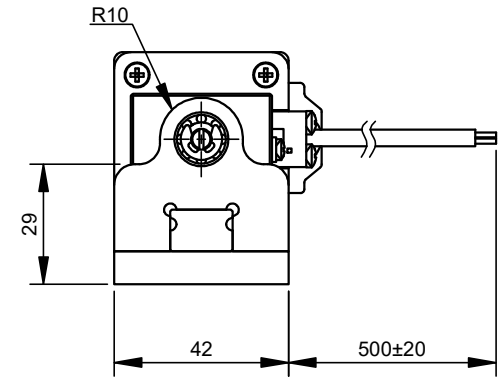
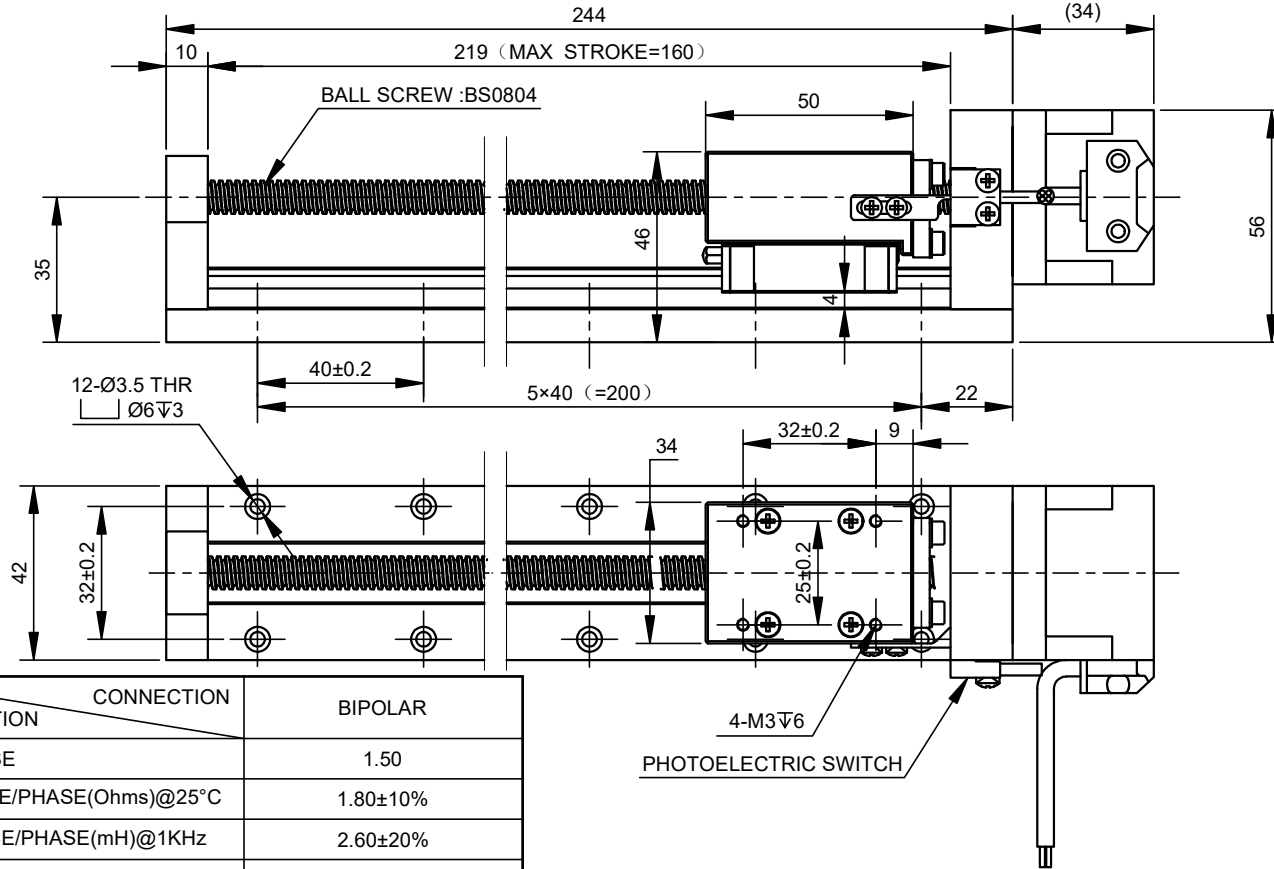

| PHOTOELECTRIC SWITCH SEQUENCE |             |       |
|-------------------------------|-------------|-------|
| PIN NO                        | BIPOLAR     | LEADS |
| 1                             | +5~24V      | BRN   |
| 2                             | GND         | BLU   |
| 3                             | SIGNAL LINE | BLK   |
| 4                             | N/A         | WHT   |

| MOTOR CONNECTION |         |         |         |
|------------------|---------|---------|---------|
| PIN NO           | BIPOLAR | LEADS   | WINDING |
| 1                | A+      | RED     |         |
| 2                | A-      | RED/WHT |         |
| 3                | B+      | GRN     |         |
| 4                | B-      | GRN/WHT |         |

| SPECIFICATION               | CONNECTION | BIPOLAR                |
|-----------------------------|------------|------------------------|
| AMPS/PHASE                  |            | 1.50                   |
| RESISTANCE/PHASE(Ohms)@25°C |            | 1.80±10%               |
| INDUCTANCE/PHASE(mH)@1KHz   |            | 2.60±20%               |
| HOLDING TORQUE(Nm)[lb-in]   |            | 0.25[2.21]             |
| MAXIMUM THRUST(N)           |            | 240                    |
| STEP ANGLE(°)               |            | 1.80                   |
| STEP ACCURACY(NON-ACCUM)    |            | ±5.00%                 |
| LEAD(mm)                    |            | 4                      |
| LINEAR TRAVEL/STEP(mm)      |            | 0.02                   |
| RATED LOAD CAPACITY(N)      |            | 220                    |
| MAX SPEED(mm/s)             |            | 120                    |
| POSITION ACCURACY(mm)       |            | ±0.02                  |
| AMBIENT TEMPERATURE         |            | -20°C~50°C[-4°F~122°F] |
| INSULATION CLASS            |            | B 130°C[266°F]         |
| TEMPERATURE RISE            |            | MAX.80°C               |

| FULL STEP 2 PHASE-Ex., WHEN FACING MOUNTING END (X) |    |    |    |    | CCW | CW | DIMENSIONS ARE IN MILLIMETERS.<br>TOLERANCES AS BELOW:<br>DECIMALS ANGLES<br>X ±0.5 ±2°<br>X.X ±0.25<br>X.XX ±0.13 |
|---|----|----|----|----|-----|----|--|
| STEP  | A+ | B+ | A- | B- |     |    |  |
| 1   | +  | +  | -  | -  |     |    |  |
| 2   | -  | +  | +  | -  |     |    |  |
| 3   | -  | -  | +  | +  |     |    |  |
| 4   | +  | -  | -  | +  |     |    |  |

THIS DOCUMENT SHALL NOT BE REPRODUCED NOR SHALL THE INFORMATION CONTAINED HEREIN BE USED BY OR DISCLOSED TO OTHERS UNLESS EXPRESSLY AUTHORIZED IN BY WRITING STEPPERONLINE.

| SIGNATURE |     | DATE      |
|-----------|-----|-----------|
| DRN       | MYX | 4.15.2026 |
| APVD      | YSX | 4.15.2026 |

**STEPPERONLINE®**

LINEAR ACTUATORS

LMD17S13BDB15-160

|      |   |       |     |         |       |
|------|---|-------|-----|---------|-------|
| REV. | 0 | SCALE | 1:1 | DWG NO. | A6570 |
|------|---|-------|-----|---------|-------|